

User Manual

B10A-20 Power Bank with Built-in Cable

Model: HKCPB2010B1

Preface

Thank you for purchasing the Huntkey products. For optimum operation, please read this manual carefully before using.

Package Contents

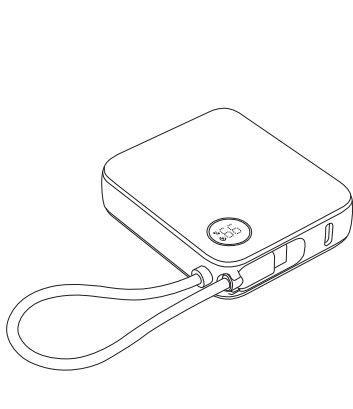

1 × Power Bank

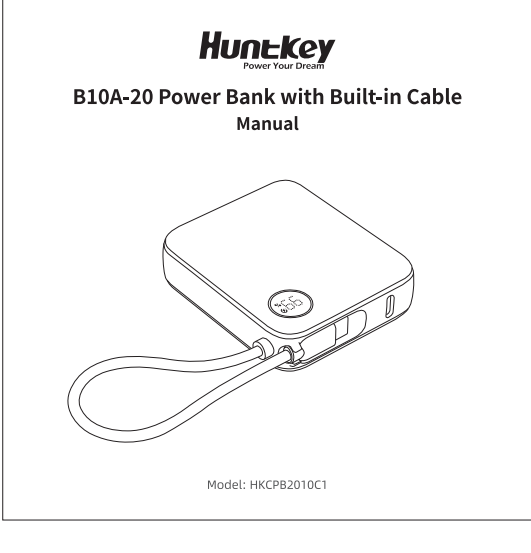

1 × User Manual

Product Overview

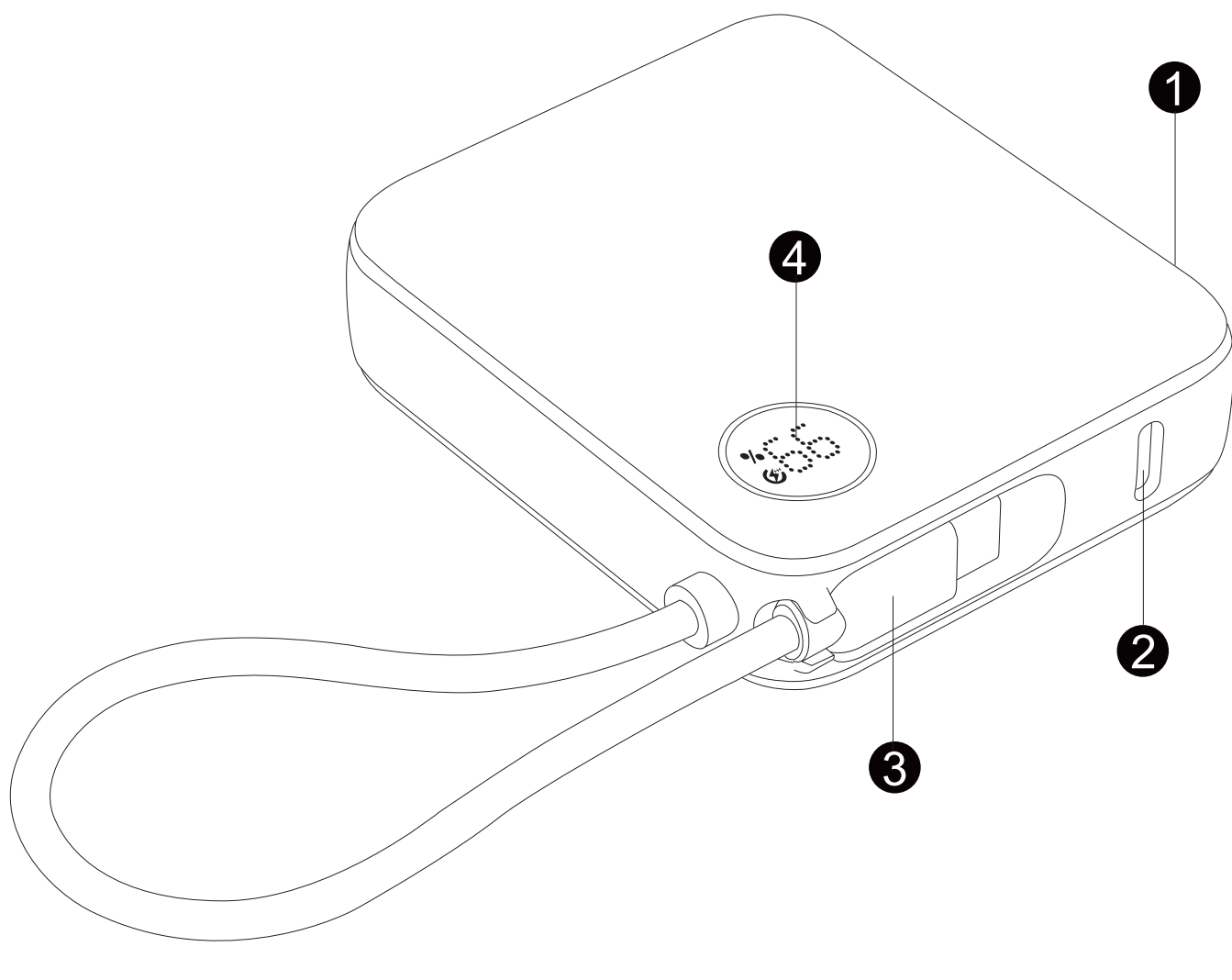

1 Power Switch

2 Type-C Input/ Output

3 Type-C Cable Input/ Output

4 Power Display

Specifications

Dimensions	74*64*24mmmm
Battery Type	Lithium-ion polymer battery
Battery Capacity	10000mAh
Lithium battery energy	10000mAh 3.85V DC/38.5Wh
Rated Capacity	6000mAh(5V \Rightarrow 2A)
Input(USB-C/USB-C Cable)	5V \Rightarrow 3A or 9V \Rightarrow 2A or 12V \Rightarrow 1.5A
Output(USB-C/USB-C Cable)	5V \Rightarrow 3A or 9V \Rightarrow 2.22A or 10V \Rightarrow 2.25A
	12V \Rightarrow 1.67A
Output(USB-C+USB-C Cable)	5V \Rightarrow 3A (Max 15W)
Charging Cable	About 150 mm/USB-C
Product Weight	200g(approximation)
Operating Temperature	-5°C~35°C
Storage Temperature	-20°C~50°C
Charging Time	About 3 hours (using a 20W power adapter)

Instructions

1. Use the supplied Type-C cable or Type-C charging port with fast charging adapter for fast input charging.

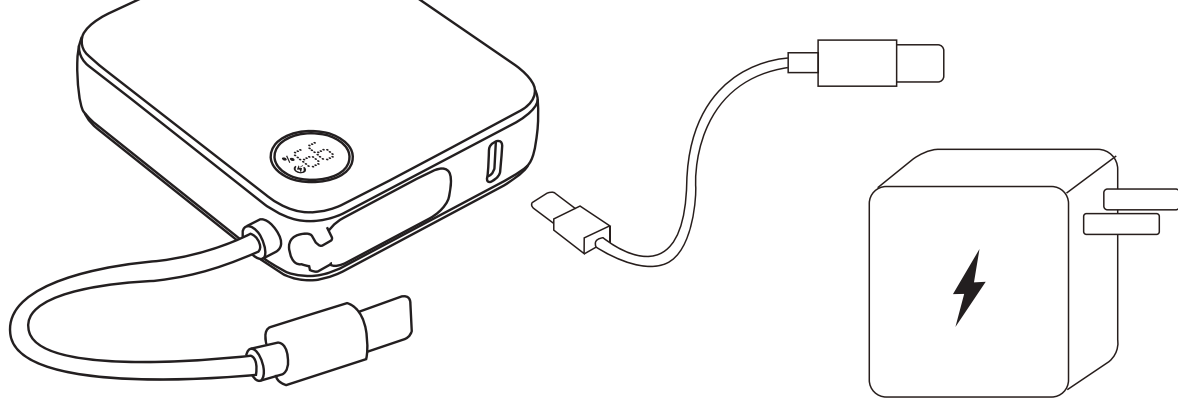

2. Use the included Type-C cable and Type-C charging port to charge two devices at the same time with fast output.

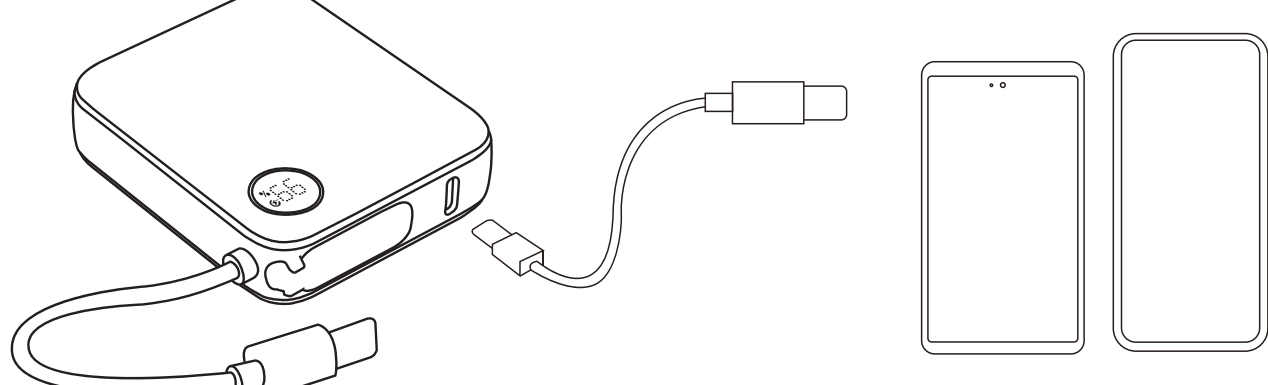

Matters needing attention

- There is a danger of explosion if the battery is not replaced properly, and it should only be replaced with a battery of the same type or an equivalent type.
- Batteries should not be exposed to environments such as sunlight, fire or similar excessive heat.
- If consumers use a power adapter for charging, they should purchase a matching power adapter that has obtained FCC certification and meets the standard requirements.
- Do not use after immersion in water.

Changes or modifications not expressly approved by the party responsible for compliance could void the user's authority to operate the equipment.

NOTE: This equipment has been tested and found to comply with the limits for a Class B digital device, pursuant to Part 15 of the FCC Rules. These limits are designed to provide reasonable protection against harmful interference in a residential installation. This equipment generates uses and can radiate radio frequency energy and, if not installed and used in accordance with the instructions, may cause harmful interference to radio communications. However, there is no guarantee that interference will not occur in a particular installation. If this equipment does cause harmful interference to radio or television reception, which can be determined by turning the equipment off and on, the user is encouraged to try to correct the interference by one or more of the following measures:

- Reorient or relocate the receiving antenna.
- Increase the separation between the equipment and receiver.
- Connect the equipment into an outlet on a circuit different from that to which the receiver is connected.
- Consult the dealer or an experienced radio/TV technician for help.

Made in China



Huntkey

Power Your Dream